

Sliding Wall



Sliding Wall - Straight Sliding Partition

Sliding Wall is a simple push/pull sliding panel system, which has been designed to replace the traditional solid core door systems that tend to warp over time and become difficult to move

Technical Specifications

Nominal thickness	70 mm
Max. panel width	1200 mm
Max. clear opening height	3100 mm
Approx. hanging weight	24-36 kg/m ²
Sound insulation range	25-42 dB

Ultimate in contemporary space management

Design option to be stored in bespoke pocket Available with vision panels

Vast selection of finishes - including veneer, laminate and white marker

Multipronged acoustic seal

Legislation compliant hardware

Panel Abutment Detail

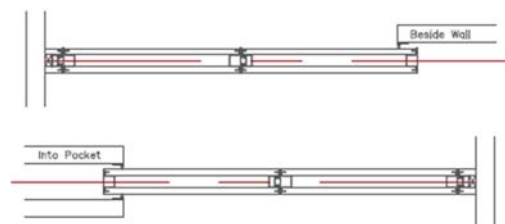

Stacking Options

